

Nu.Q® Vet Cancer Test in everyday practice | Element i+

Collecting a sample



Draw 100 µL

From peripheral or jugular vein



Fill EDTA tube

Gently invert 10 times



Centrifuge sample on blood setting

For 10 minutes within 1 hour of collection



Extract plasma

Transfer to non-additive tube
(Avoid disrupting buffy coat)

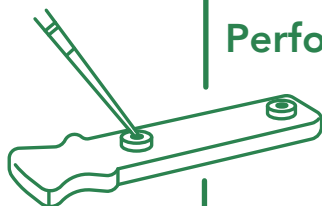

Perform test using Element i+

50µL of extracted plasma is tested

Results in under 6 minutes with no need to refrigerate

Allows you to make informed clinical decisions quickly while the patient is still in clinic



Available through:

Antech



Test Code - 313100

Heska VDL